

PROPOSAL

For Great Ashby Community Council to consider a request to support a new cycle track and shared-use path to link Great Ashby to the Stevenage Cycle Track System.

Great Ashby already has a number of sections of shared-use paths that allow cyclists to travel safely and legally off the carriageway, but currently formal off-road cycling links to the Stevenage Cycle Track system are incomplete.

There are many active cyclists in Great Ashby and, where the cycle routes stop, this doesn't stop cyclists, who continue to cycle on footways – hopefully with care.

By lending support to this proposal GACC can demonstrate an active interest in safety and the environment. In the expectation that proposed developments GA1 and GA2 will both eventually be built, improving and extending cycle links between Great Ashby and Stevenage would seem to be a good idea and worth promoting by GACC.

As a member of the resurrected **Friends of Great Ashby** group, I've prepared an outline design for a new cycle track and a shared-use path to link Great Ashby to the Stevenage Cycle Track System to remove conflicts between pedestrians and cyclists.

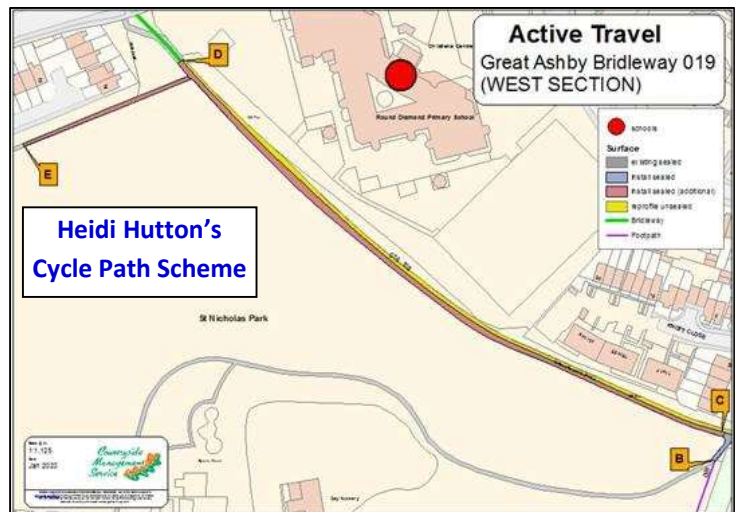

This design builds on an existing scheme designed, commissioned and part-funded by Heidi Hutton of Hertfordshire County Council, and half of that scheme has been constructed.

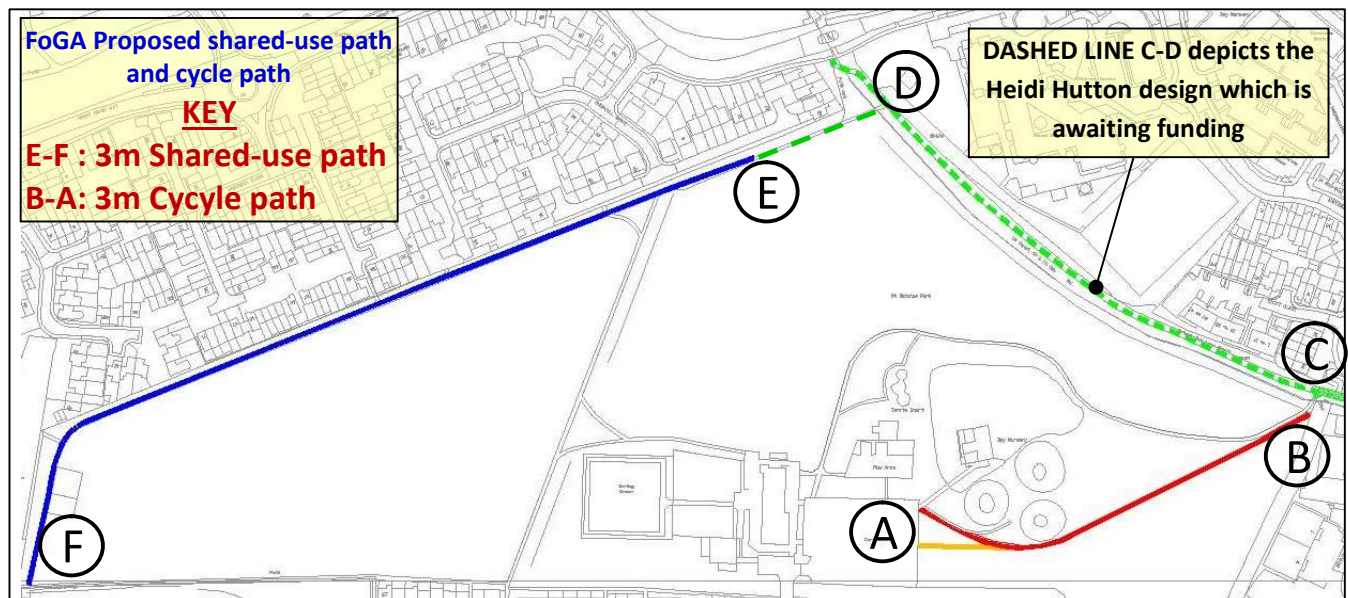

The approximate cost of sections **C to D**, **B to A** & **E to F** based on current contractor rates is £65k. GACC have the power to take a low-interest Government loan to cover all or part of this. The annual cost of funding this entirely would be approximately £3,400 or £280/month but part-funding might be available from HCC.